

LATITUDE :- 22.69671
LONGITUDE :- 88.48553

LATITUDE :- 22.69686
LONGITUDE :- 88.48624

LATITUDE :- 22.69531
LONGITUDE :- 88.48479

LATITUDE :- 22.69371
LONGITUDE :- 88.48661

LATITUDE :- 22.69391
LONGITUDE :- 88.48737

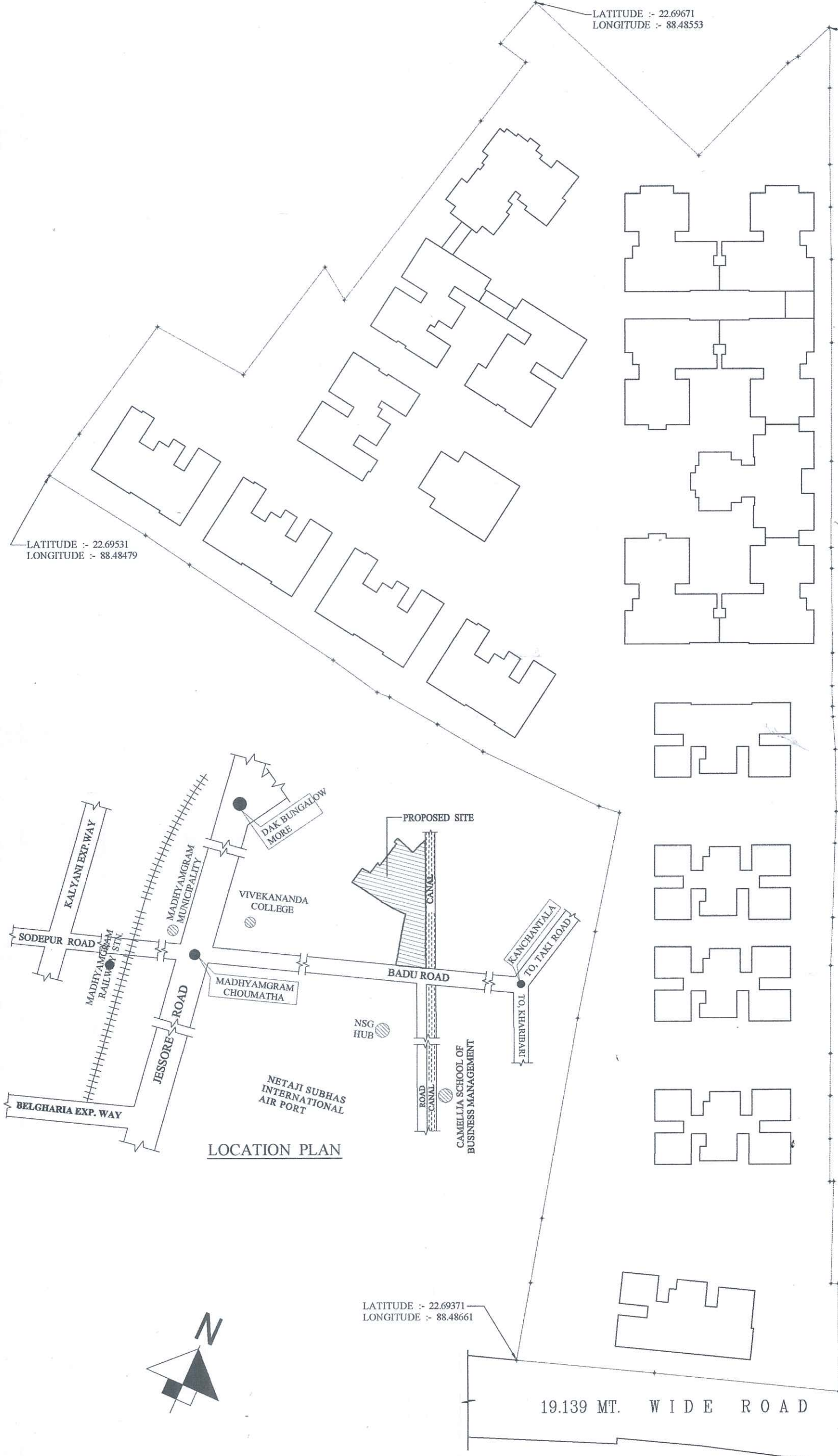

LOCATION PLAN

SITE PLAN WITH CO-ORDINATES

SCALE - NTS

PROJECT:
 SITE PLAN FOR SWADHA NIRMAN PVT. LTD. & OTHERS AT HOLDING NO. - 1048, KUTULSAHI ROAD, MOUZA - KUTULSAHI, UNDER BARASAT MUNICIPALITY, WARD NO.- 29, P. S. - BARASAT, DIST. - 24 PGS.(N) P.S - BARASAT, DIST - 24 PGS(N) & AT DAG NO - 21/560, MOUZA - DIGBERIA UNDER MADHYAMGRAM MUNICIPALITY, WARD NO -4 (Formerly known as ward No.12), P.S- MADHYAMGRAM, DIST- 24 PGS. (N)

Raj Kumar Agarwal

Rajkumar Agarwal
 Architect
 Member of Council of
 Architecture CA / 94 / 17940
 SIGNATURE OF ARCHITECT

 **RAJ AGRAWAL & ASSOCIATES**
 8B, ROYD STREET, KOLKATA - 16